

PROJECT

Chester Springs Lease Outline Drawing (LOD)

PROJECT LOCATION
BLOCK: xxx LOT: xxx
270 Route 206
Chester NJ 07930

ARCHITECT

B^{en}**HORTEN**
architecture & design
312 State Route 10, Randolph, NJ 07869
Tel: 973.442.5880 Fax: 973.442.5886

CONSULTANT

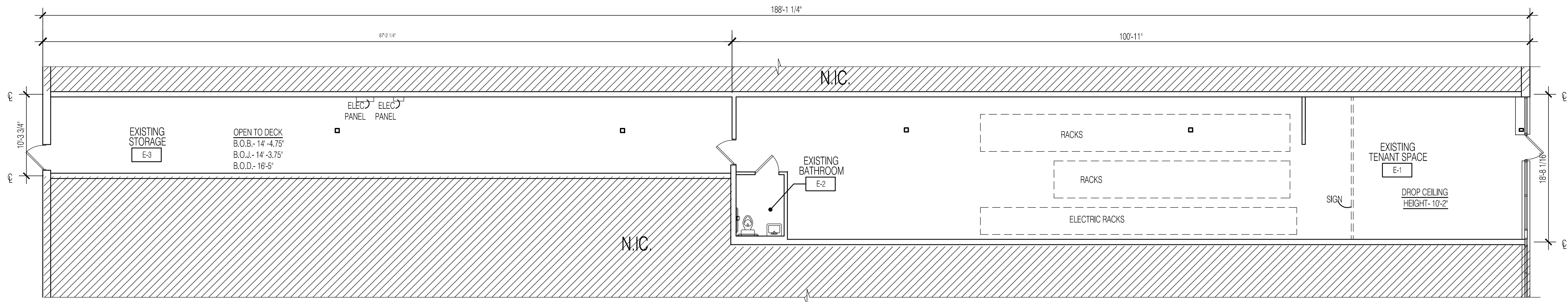

UNIT AREA 2,775 S.F.
MEASURED OUTSIDE FACE OF EXTERIOR WALL, CENTER OF TENANT DEMISING WALL.
(WALL THICKNESS ASSUMED TO BE 8" THICK.)

ISSUES & REVISIONS					
No.	Date	Issues and Revisions	By	Check	
1.	01/05/17	SURVEY	AB	BH	

REGISTRATION & SIGNATURE

Benjamin J. Horten NJ Licence No: 21AI 01579400
Drawing Description:
FIRST FLOOR: EXISTING PLAN
Computer File:
L:\17101_Chester Spring
LOD\drawings\survey\Xplan_01_unit240_CN.dwg

SHEET

LOD-240

All drawings and written material appearing herein constitute original and unpublished work of the architect and may not be duplicated, used or disclosed without written consent of the architect.
© 2017 BEN HORTEN ARCHITECTURE & DESIGN All Rights Reserved