

PROJECT

Chester Springs Lease Outline Drawing (LOD)

PROJECT LOCATION
BLOCK: xxx LOT: xxx
270 Route 206
Chester NJ 07930

ARCHITECT

B^{en}**HORTEN**
architecture & design
312 State Route 10, Randolph, NJ 07869
Tel: 973.442.5880 Fax: 973.442.5886

CONSULTANT

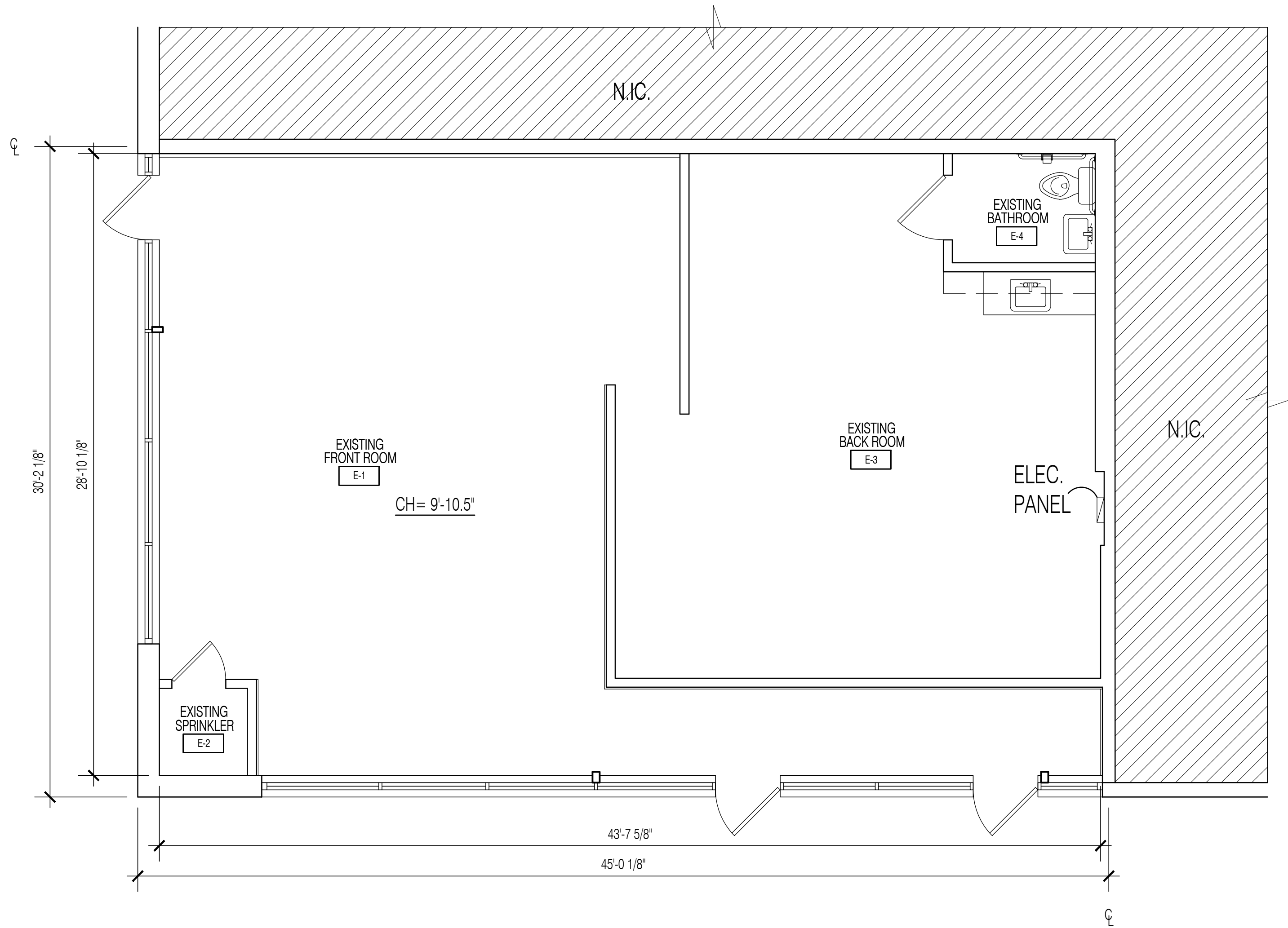

UNIT 160
UNIT AREA 1,358 S.F.
MEASURED OUTSIDE FACE OF EXTERIOR WALL, CENTER OF TENANT DEMISING WALL.
(WALL THICKNESS ASSUMED TO BE 8" THICK.)

- LEGEND:
- EXISTING SLAT WALL
 - EXISTING WALL
 - EXISTING WINDOW
 - EXISTING DOOR
 - POST
 - ROOM TAG

ISSUES & REVISIONS					
No.	Date	Issues and Revisions	By	Check	
1.	05/18/17	SURVEY	AB	BH	

REGISTRATION & SIGNATURE

Benjamin J. Horten NJ Licence No: 21AI 01579400

Drawing Description:

FIRST FLOOR: EXISTING PLAN

Computer File:

L:\17101_Chester Spring LOD\drawings\survey\Xplan_01_unit160_CN.DWG

SHEET

LOD-160

All drawings and written material appearing herein constitute original and unpublished work of the architect and may not be duplicated, used or disclosed without written consent of the architect.
©2017 BEN HORTEN ARCHITECTURE & DESIGN All Rights Reserved